



FITTED
TO
LAST

PRODUCT CATALOGUE



Company & Technology

Coating and Technology	02
About Vita	03

Fittings for Windows

Claymore Window Handles

HB 117	05
HB 118	07
HB 119	09

Window Espagnolettes

SBR	11
IEB	13
SEB	15

Katana Friction Stays

FS	17
----------	----

Window Restrictors

WR	19
----------	----

Fittings for Doors

Claymore Door Handles

DH 311	21
DH 314	23
DH 312	25
DH 313	27

Claymore 3-D Door Hinges

FH 090	29
FH 103	31

Claymore Letterplate

KPLP	33
------------	----

Door Knocker

DK - DKV	35
----------------	----

ABS Framed Letterplate

LTP	37
-----------	----

Door Locks

Scimitar (for PVC-u)	39
----------------------------	----

Avantis (for Composite/Timber).....	41
-------------------------------------	----

Door Cylinders

DC	43
----------	----

Door Restrictor

DR	45
----------	----

VITA- COATING TECHNOLOGY



Porcel Coat™ – A Revolution in Coating Technology.

Porcel Coat™ delivers 10 times (3,000 hours) the corrosion resistance of today's highest quality window and door hardware and double the lifespan of standard hardware. Protect your window and door investment with Vita fittings that resist corrosion and day-to-day wear and tear, providing unmatched durability.

- BO Black Onyx
- LB Lava Brown
- MG Moët Gold

Vita Electrophoretic Lacquer

Vita Electrophoretic Lacquer is an excellent choice for an evenly-coated surface, lasting 240 hours (Grade 4) under neutral salt spray testing.

- GN Gold New

Vita Powder Coat

Vita Powder Coat exceeds Grade 5 (480 hours) during neutral salt spray tests and offers bespoke colour choices.

- WH White
- CA Caramel
- BK Black
- BR Brown

Vita Physical Vapour Deposition (PVD)

PVD is resistant to abrasive environments, exceeding Grade 5 (480 hours) under neutral salt spray testing and offers bespoke colour choices.

- VG Polished Gold PVD
- VC Polished Chrome PVD
- VS Smoked Chrome PVD
- VA Satin Silver PVD

Vita Electro-Plating

Vita Electro-Plating offers lustrous and pleasing finishes, and meets Grade 4 (240hours) under neutral salt spray testing and offers bespoke colour choices.

- PC Polished Chrome
- SK Smoked Chrome
- SA Satin Silver

Vita Anodised

Vita Anodised products provide a fine decorative finish and meet Grade 4 (240 hours) under natural salt spray testing.

- SS F1 Silver Anodised
- SA F3 Gold Anodised

About Vita

At the heart of our success is the Vita Comprehensive Manufacture and Supply Model. Thanks to our integrated supply chain, with fully owned production plants in Taiwan and China, we can offer the best quality in the marketplace.

Due to us owning engineering and manufacturing facilities, we have the in-house expertise to quickly develop new products according to our end customers' needs. In the twenty-eight years since the company's founding we have followed only one target, i.e. our aim to be the creator of sturdy, lasting and easily fitted hardware for windows and doors – and the same still holds true today.

We have found out that coating technology is a vital one for our industry, which, if applied with absolute care, not only makes the hardware more aesthetically pleasing to the eye but also more durable.

We are looking forward to adding to our ever-expanding range of applications, to fulfill our goal of producing window and door hardware that is “Fitted to Last”.

Our Quality

A team of local professionals carries out all customer care and aftersales support from our sales office in Elland, because we think that only UK based people have a full understanding of customer needs in their area. However, this local team is also in permanent contact with our engineers in Germany, Taiwan and China, to make sure that we can provide our customers what they really need.

Double Crank Press



De-Coiler



Cycle Testing



Neutral Salt Spray Testing



Hardness Testing



Forming



The quality management system of all of our Far East plants is certified to ISO 9001 by the German TÜV.

Before we introduce a product to the UK market it goes through extensive testing. For example, our handles are tested for durability by the BBA to outlast 25,000 cycles. In addition to this normal type of endurance testing, which is mostly certified by high reputation testing institutes such as: British BSI and BBA, German PIV and ift and Dutch SKG, Vita carries out rigorous in-house testing in its own testing centers in Taiwan and Germany.

Therefore, to reflect our confidence in our products, we offer 10 year warranty for all mechanical parts and 2 year PVD surface finish warranty.

Fitted to Last



Fittings for Windows 5



FEATURES & BENEFITS

- Tested in accordance to BBA
- Six suited finishes
- High profile to give greater knuckle clearance during operation
- Non-handed for ease of stocking
- Push-to-open locking mechanism
- Available in locking or non-locking variants
- Green button available for fire egress applications
- Colour co-ordinated screw covers
- Profile-specific spindle lengths
- Packaged as 10 per box, 6 boxes per carton

INLINE WINDOW
HANDLE
HB 117

The inline window handle is engineered to work with all standard espagnolette and shoot bolt mechanisms with 43mm centres. Suitable for PVC-u, Aluminium and Timber window profiles, this range offers outstanding performance and reliability. Aimed at the prestigious end of the market, the Claymore inline window handle is produced to meet the demands associated with the new build and commercial sectors, while still retaining the aesthetical and contemporary design that appeals to the domestic and trade fabricator.

CLAYMORE

Fitted to Last



Fittings for Windows 6

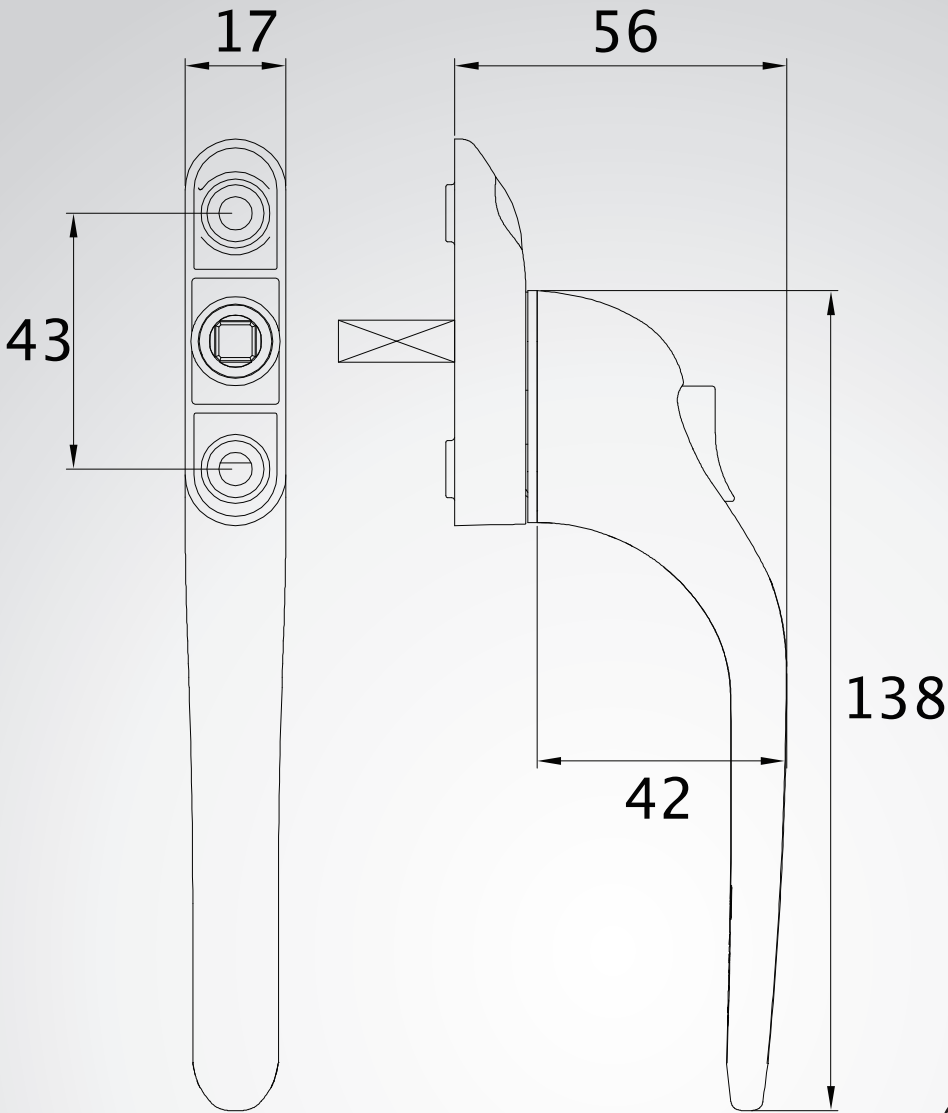

BBA Assessment Report No.S2/49995

Colour	Coating Type	BS EN 1670 : 2007
White	Powder Coat	Grade 5 (480 hours)
Black	Powder Coat	Grade 5 (480 hours)
Polished Gold	Electrophoretic Lacquer	Grade 4 (240 hours)
Polished Chrome	Electro-Plating	Grade 4 (240 hours)
Smoked Chrome	Electro-Plating	Grade 4 (240 hours)
Satin Silver	Electro-Plating	Grade 4 (240 hours)

Product Code	Product Type	Available Spindles
HB 117PK	Locking	10, 15, 20, 25, 30, 35, 43, 45, 50
HB 117P	Non-locking	
HB 117PE	Egress	

AVAILABLE COLOURS

- White
- Black
- Polished Gold
- Polished Chrome
- Smoked Chrome
- Satin Silver

Fitted to Last



Fittings for Windows 7



FEATURES & BENEFITS

- Tested in accordance to BBA
- Six suited finishes
- High profile to give greater knuckle clearance during operation
- Left and right hand variant available, with positive stop location
- Push-to-open locking mechanism
- Available in locking or non-locking variants
- Green button available for fire egress application
- Colour co-ordinated screw covers
- Profile-specific spindle lengths
- Packaged as 10 per box, 6 boxes per carton

OFFSET WINDOW
HANDLE
HB 118

The Claymore offset window handle is engineered to work with all standard espagnolette and shoot bolt mechanisms with 43mm centres. Suitable for PVC-u, Aluminium and Timber window profiles, this range offers outstanding performance and reliability. Aimed at the prestigious end of the market, the Claymore offset handle is produced to meet the demands associated with the new build and commercial sectors, while still retaining the aesthetics and contemporary design that appeals to the domestic and trade fabricator.

CLAYMORE

Fitted to Last



Fittings for Windows 8

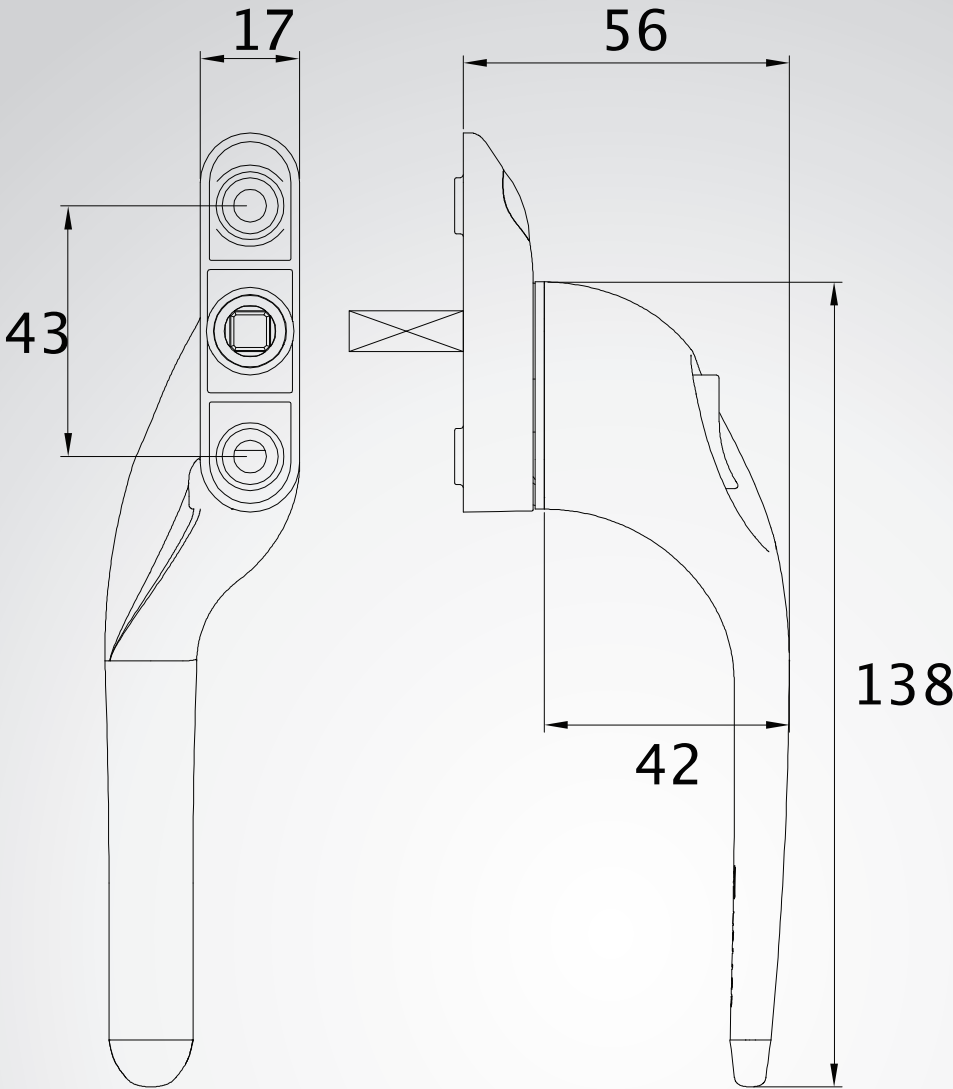

BBA Assessment Report No.S2/49995

Colour	Coating Type	BS EN 1670 : 2007
White	Powder Coat	Grade 5 (480 hours)
Black	Powder Coat	Grade 5 (480 hours)
Polished Gold	Electrophoretic Lacquer	Grade 4 (240 hours)
Polished Chrome	Electro-Plating	Grade 4 (240 hours)
Smoked Chrome	Electro-Plating	Grade 4 (240 hours)
Satin Silver	Electro-Plating	Grade 4 (240 hours)

Product Code	Product Type	Available Spindles
HB 118PK	Locking	10, 15, 20, 25, 30, 35, 43, 45, 50
HB 118P	Non-locking	
HB 118PE	Egress	

AVAILABLE COLOURS

- White
- Black
- Polished Gold
- Polished Chrome
- Smoked Chrome
- Satin Silver

Fitted to Last



Fittings for Windows 9



FEATURES & BENEFITS

- Tilt first facility, two-stage key operation
- Six suited finishes
- Available in locking or non-locking variants
- Colour co-ordinated screw covers
- One key type for all tilt & turn and casement window handles
- Profile specific spindle lengths
- Suitable for use with tilt and turn gearing, various espagnolette bolts and shootbolt mechanisms
- Suitable for use on PVC-u, Aluminum and Timber windows
- Packaged as 10 per box, 6 boxes per carton

TILT FIRST
WINDOW
HANDLE
HB 119

The Claymore tilt first (tbt) window handle was developed to cater for the needs of both domestic and commercial tilt & turn applications. This is achieved with a two-stage key operation which offers a tilt only facility to control ventilation, along with a fully locked position.

CLAYMORE

Fitted to Last



Fittings for Windows 10

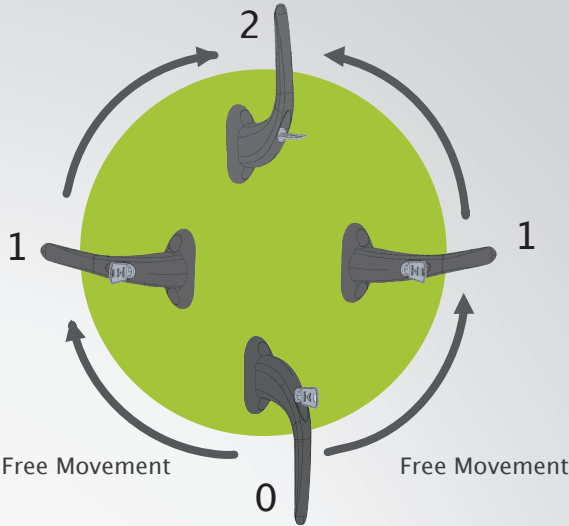
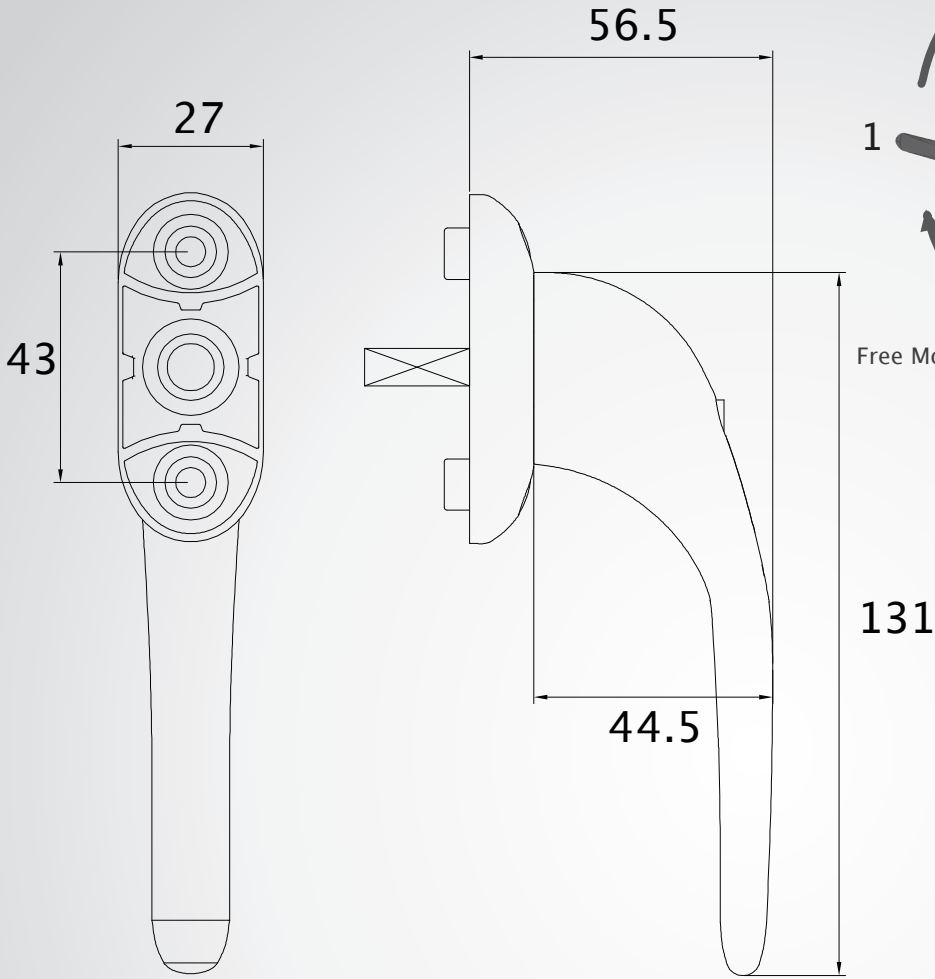

Zero Position:
Fully locked in closed position

Key stage 1:
Tilt only mode for ventilation

Key stage 2:
Fully unlocked in turn mode



Colour	Coating Type	BS EN 1670 : 2007
White	Powder Coat	Grade 5 (480 hours)
Black	Powder Coat	Grade 5 (480 hours)
Polished Gold	Electrophoretic Lacquer	Grade 4 (240 hours)
Polished Chrome	Electro-Plating	Grade 4 (240 hours)
Smoked Chrome	Electro-Plating	Grade 4 (240 hours)
Satin Silver	Electro-Plating	Grade 4 (240 hours)

Product Code	Product Type	Available Spindles
HB 119K	Locking	30, 35, 43
HB 119P	Non-locking	

AVAILABLE COLOURS

- White
- Black
- Polished Gold
- Polished Chrome
- Smoked Chrome
- Satin Silver

Fitted to Last



FEATURES & BENEFITS

- Designed to meet the requirements of PAS 24
- Tested in accordance to BBA
- Suitable for eurogroove applications
- Available in four croppable standard sizes for ease of stocking
- Suitable for sash rebates 344 to 1500mm
- Fully adjustable mushroom cams +/-1mm
- One-piece corner keep for greater security
- Extensive range of profile specific night vent keeps available
- Packaged as 10 per box, 3, 5 or 10 boxes per carton depending on Espagnolette size

Fittings for Windows 11



SHOOTBOLT LOCKING SYSTEM

Vita's high security bi-directional shootbolt locking system simultaneously inserts two corner drives into security keeps.

With the additional aid of conventional mushrooms for gasket compression and security, the SBR is the safest choice for fabricator and user alike.

Fitted to Last

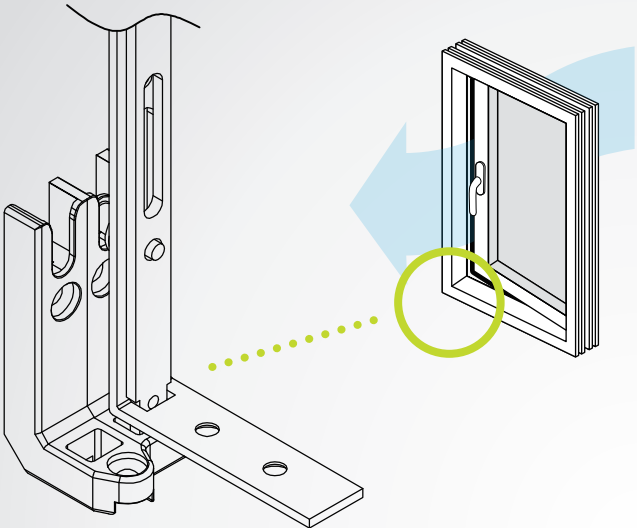
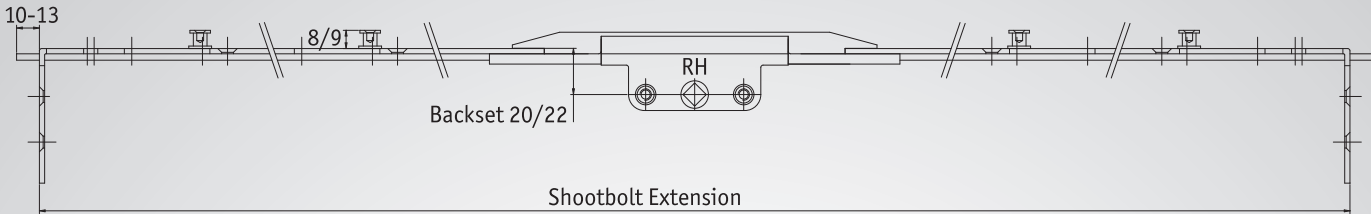

SEBseries
FOR 3

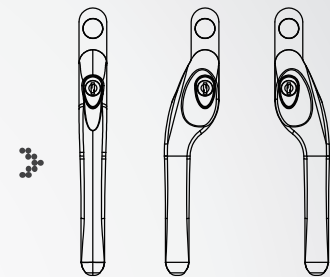

HB 117 HB 118L HB 118R



Fittings for Windows 12

Silver Trivalent coating to BS EN 1670:2007 Grade 3
BBA Assessment Report Number S2/49995

Product Code	Description	Application Sash Rebate (mm)	Backset (mm)	Mushroom Height (mm)
SGB 20-S	gear box		20	
SGB 22-S	gear box		22	
Product Code	Description	Application Sash Rebate (mm)	Backset (mm)	Mushroom Height (mm)
SBR 34-S	extension	344 - 540		
SBR 48M8-S	extension	428 - 800		8
SBR 48M9-S	extension	428 - 800		9
SBR 812M8-S	extension	800 - 1200		8
SBR 812M9-S	extension	800 - 1200		9
SBR 1215M8-S	extension	1200 - 1500		8
SBR 1215M9-S	extension	1200 - 1500		9



FEATURES & BENEFITS

- Tested in accordance to BBA
- Suitable for eurogroove applications
- Quick and easy to fabricate
- Available in a range of lengths to fit all window sash sizes
- Fully adjustable mushroom cams +/-1mm
- Extensive range of profile specific night vent keeps available
- Packaged as 10 per box, 3, 5 or 10 boxes per carton depending on Espagnolette size

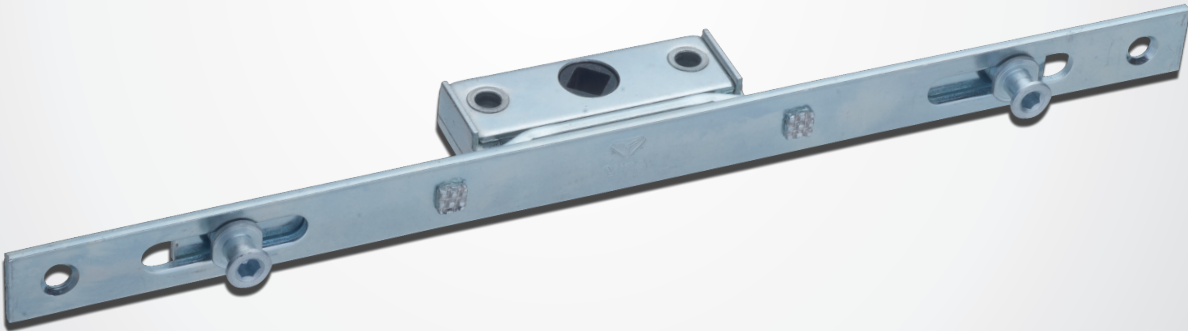

IEB INLINE
ESPAGNOLETTE

The Vita Inline Espagnolette range has been designed to meet the requirements of both trade and newbuild fabricators requiring a high quality, high performance product that meets the stringent requirements of BBA. Manufactured from quality steel throughout and quick and easy to fabricate. Available in 20 or 22mm backsets with 8mm or 9mm mushroom cams.

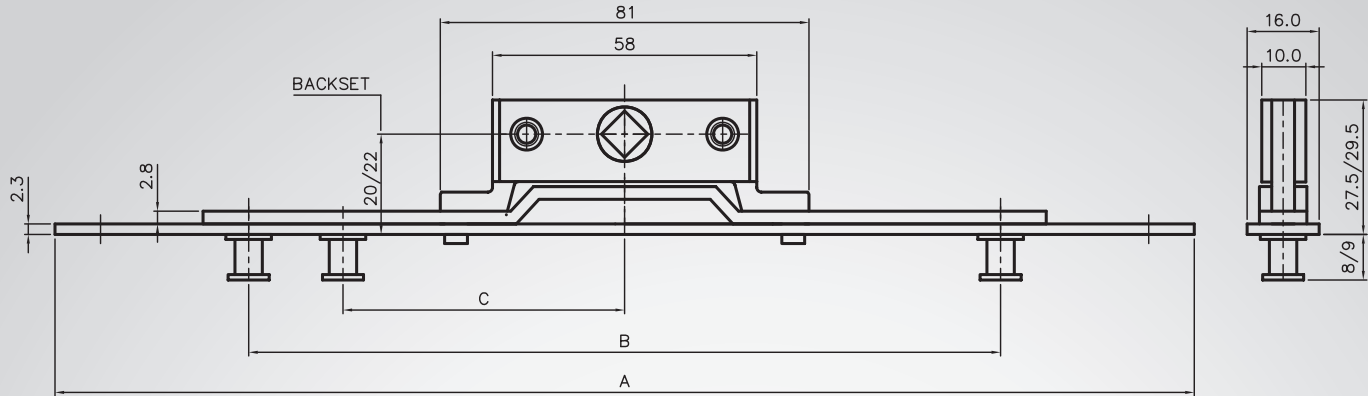

IEBseries
FOR ➤

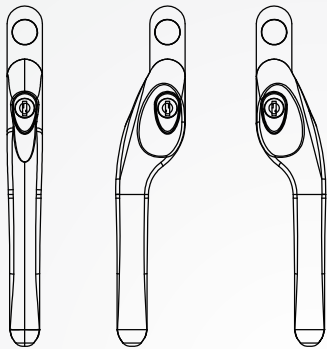

HB 117 HB 118L HB 118R



Silver Trivalent coating to BS EN 1670:2007 Grade 3
BBA Assessment Report Number S2/49995

Product Code	Size A (mm)	Locking Cams	Distance B (mm)	Distance C (mm)
IEB150	150	1	-	-
IEB250	250	2	165	-
IEB400	400	2	284	-
IEB600	600	2	484	-
IEB800	800	2	684	-
IEB1000	1000	3	884	148.5
IEB1200	1200	3	1084	148.5

Product Code	Size (mm)	Backset (mm)	Mushroom Height (mm)	Product Code	Size (mm)	Backset (mm)	Mushroom Height (mm)
IEB22M8L150	150	22	8	IEB22M9L150	150	22	9
IEB22M8L250	250	22	8	IEB22M9L250	250	22	9
IEB22M8L400	400	22	8	IEB22M9L400	400	22	9
IEB22M8L600	600	22	8	IEB22M9L600	600	22	9
IEB22M8L800	800	22	8	IEB22M9L800	800	22	9
IEB22M8L1000	1000	22	8	IEB22M9L1000	1000	22	9
IEB22M8L1200	1200	22	8	IEB22M9L1200	1200	22	9
Product Code	Size (mm)	Backset (mm)	Mushroom Height (mm)	Product Code	Size (mm)	Backset (mm)	Mushroom Height (mm)
IEB20M8L150	150	20	8	IEB20M9L150	150	20	9
IEB20M8L250	250	20	8	IEB20M9L250	250	20	9
IEB20M8L400	400	20	8	IEB20M9L400	400	20	9
IEB20M8L600	600	20	8	IEB20M9L600	600	20	9
IEB20M8L800	800	20	8	IEB20M9L800	800	20	9
IEB20M8L1000	1000	20	8	IEB20M9L1000	1000	20	9
IEB20M8L1200	1200	20	8	IEB20M9L1200	1200	20	9



FEATURES & BENEFITS

- Suitable for non-eurogroove applications
- Quick and easy to fabricate
- Available in a range of lengths to fit all window sash sizes
- Fully adjustable mushroom cams +/- 1mm
- Extensive range of profile specific night vent keeps available
- Packaged as 10 per box, 3, 5 or 10 boxes per carton depending on Espagnolette size



SEB OFFSET
ESPAGNOLETTE

The Vita Offset Espagnolette range has been designed to meet the requirements of both trade and newbuild fabricators who need a high quality, high performance product that meets the stringent standards of the window and door industry. Manufactured from quality steel throughout and quick and easy to fabricate. Available in 20 or 22mm backsets with 8mm or 9mm mushroom cams.

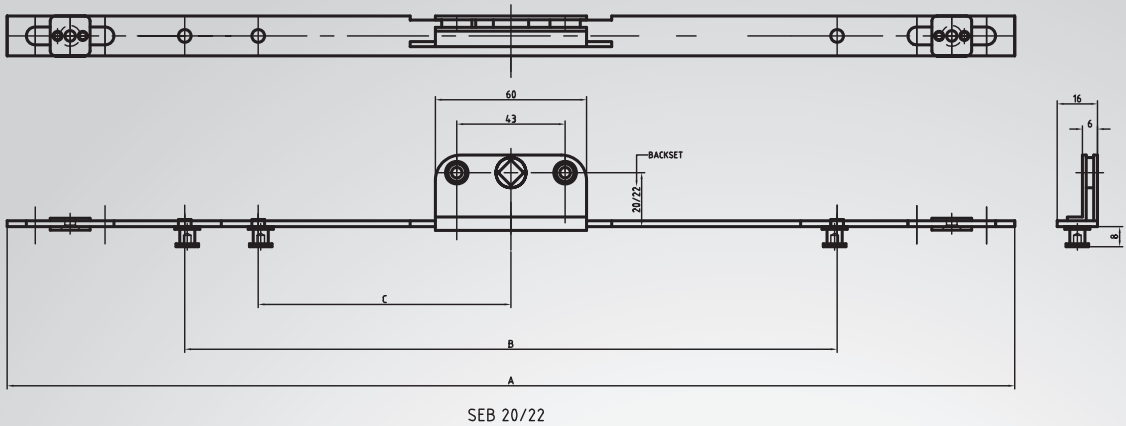

SEBseries
FOR 3

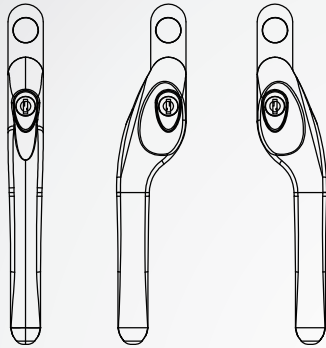

HB 117 HB 118L HB 118R

Product Code	Size A (mm)	Locking Cams	Distance B (mm)	Distance C (mm)
SEB250	250	1	155	-
SEB400	400	2	259	-
SEB600	600	2	459	-
SEB800	800	2	659	-
SEB1000	1000	3	859	132
SEB1200	1200	3	1059	132



Silver Trivalent
coating to BS EN
1670:2007 Grade 3

Product Code	Size (mm)	Backset (mm)	Mushroom Height (mm)	Product Code	Size (mm)	Backset (mm)	Mushroom Height (mm)
SEB22M8L250	250	22	8	SEB22M9L250	250	22	9
SEB22M8L400	400	22	8	SEB22M9L400	400	22	9
SEB22M8L600	600	22	8	SEB22M9L600	600	22	9
SEB22M8L800	800	22	8	SEB22M9L800	800	22	9
SEB22M8L1000	1000	22	8	SEB22M9L1000	1000	22	9
SEB22M8L1200	1200	22	8	SEB22M9L1200	1200	22	9
Product Code	Size (mm)	Backset (mm)	Mushroom Height (mm)	Product Code	Size (mm)	Backset (mm)	Mushroom Height (mm)
SEB20M8L250	250	20	8	SEB20M9L250	250	20	9
SEB20M8L400	400	20	8	SEB20M9L400	400	20	9
SEB20M8L600	600	20	8	SEB20M9L600	600	20	9
SEB20M8L800	800	20	8	SEB20M9L800	800	20	9
SEB20M8L1000	1000	20	8	SEB20M9L1000	1000	20	9
SEB20M8L1200	1200	20	8	SEB20M9L1200	1200	20	9

Fitted to Last



FEATURES & BENEFITS

- Tested in accordance to BBA
- Available in Top Hung and Side Hung variants for 13 and 17mm stack height applications
- Manufactured from SUS 430 ferretic stainless steel
- Fire egress option available
- Suitable for all major profiles
- Quick and easy to fabricate
- Smooth glide operation



Fittings for Windows 17

HANDED STAY

The Vita handed friction stay range has been designed to ensure enhanced weather performance, smooth operation and durability for the life of the window.

The Vita "Sureclose" Nylon friction end cap guarantees a positive engagement of the sash and the frame part, optimising gasket compression.

KATANA

Fitted to Last

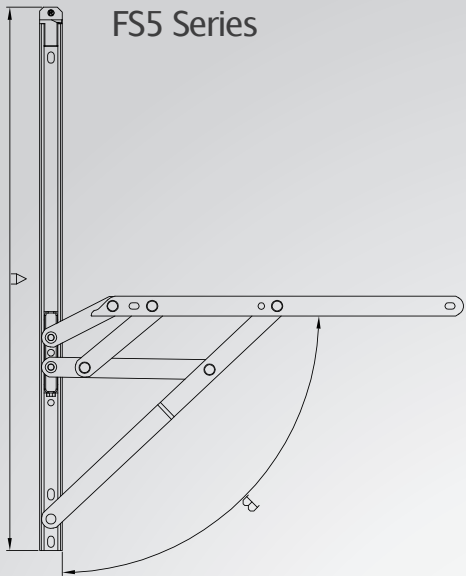

FS5 Series

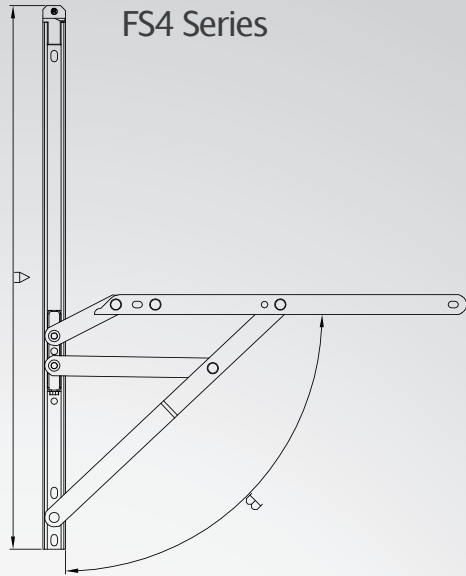

FS4 Series

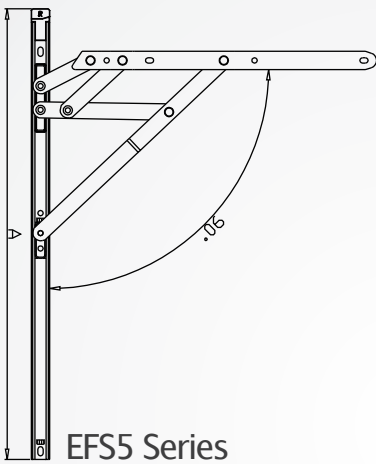

EFS5 Series

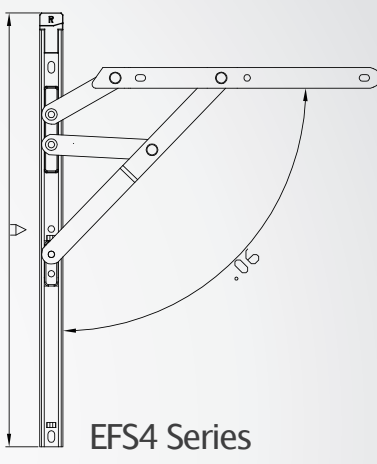

EFS4 Series

Material:

- Links & Track, Rivet – Stainless Steel
- Slider – Nylon
- Screws – Brass



Sureclose Nylon friction end cap



Fittings for Windows 18

BBA Assessment Report Number: S2/49995

RECOMMENDED MAXIMUM WINDOW WEIGHTS AND SIZES

Product Code	Size A	Application	Approx. Sash Width	Approx. Sash Height	Approx. Sash Weight	Stack height	Opening Angle B
FS408	8"	Top hung	1200mm	350mm	12kg	13mm & 17mm	60
FS410	10"	Top hung	1200mm	400mm	14kg	13mm & 17mm	60
FS412	12"	Top hung	1200mm	550mm	16kg	13mm & 17mm	90
FS416	16"	Top hung	1200mm	800mm	20kg	13mm & 17mm	65
FS520	20"	Top hung	1200mm	900mm	24kg	13mm & 17mm	50
FS524	24"	Top hung	1200mm	1300mm	50kg	13mm & 17mm	44
FS512	12"	Side hung	600mm	1200mm	22kg	13mm & 17mm	55
FS516	16"	Side hung	700mm	1350mm	24kg	13mm & 17mm	65
EFS412	12"	Side hung	600mm	1200mm	22kg	13mm & 17mm	90
EFS516	16"	Side hung	700mm	1350mm	24kg	13mm & 17mm	90



FEATURES & BENEFITS

Fittings for Windows 19



- Complies with BS EN 14351-1:2006
- CE compliant
- An extensive range of stud heights are available for PVC-u, Aluminium and Timber applications
- Concealed and hidden from view
- Manufactured from SUS 430 stainless steel (Austenitic 304 stainless option for coastal locations)
- Packaged as 50 per box

AUTOLATCH
WINDOW
RESTRICTOR

The Vita Autolatch window restrictor is suitable for use on PVC-u, Aluminium and Timber windows. When fitted, it is fully concealed from view and operates within the airgap between sash and frame. Designed to give an initial opening on casement windows, the spring loaded arm automatically engages with a stud, with disengagement required via a manual operation.



Fittings for Windows 20

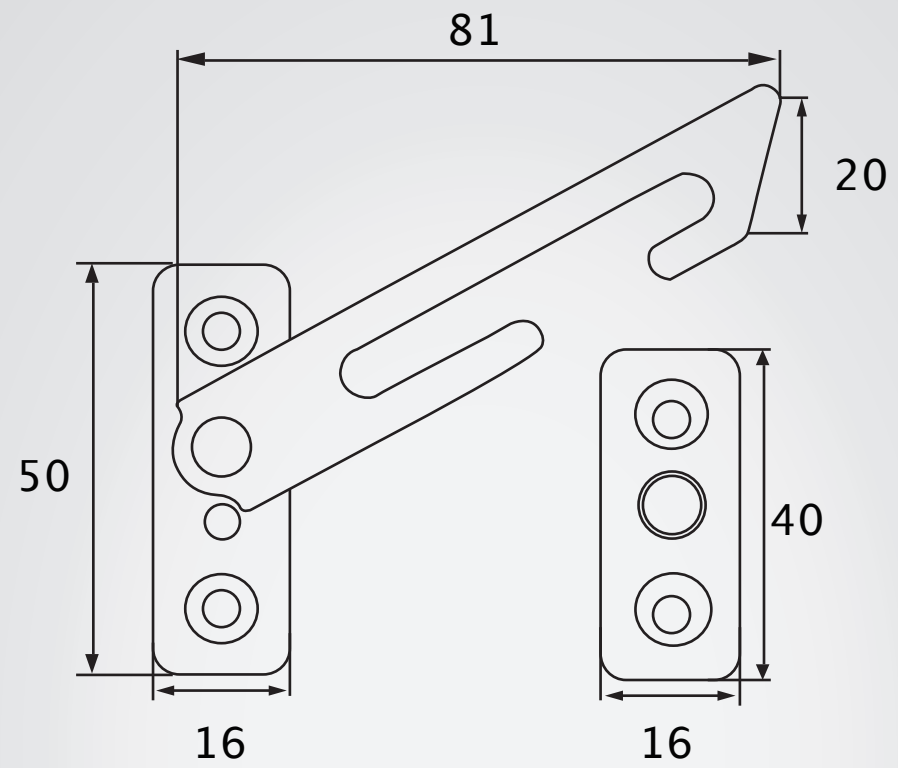

Product Code	Stud Height
WRSTUD9.5	9.5mm
WRSTUD10.5	10.5mm
WRSTUD11.5	11.5mm
WRSTUD13.5	13.5mm
WRSTUD13.5	14.5mm

Manufactured from SUS 430 stainless steel as standard (BS EN 1670:2007 Grade 3), with the option of SUS Austenitic 304 stainless for coastal locations.

Fitted to Last



Fittings for Doors 21



FEATURES & BENEFITS

- Lever/lever variant: non-handed
- Suitable for 92 PZ centres
- 30mm backplate width; blank backplate option available to special order
- Spring cassette option
- Supplied with 1x8mm spindle and screw pack included as standard for 70mm door thickness
- Die-cast Aluminium or Zinc Alloy
- 2 year surface finish guarantee thanks to durable PVD coating
- Colour co-ordinated screw heads
- Packed as 1 pair per box, 20 boxes per carton

DOOR HANDLE
DH 311

This lever/lever door handle compliments the Claymore series of window handles, hinges and Zinc framed letterplates. Designed for applications where a short backplate is required, the fixings are sited below the handle grip. The door handle is designed to incorporate two internal spring cassettes if required, to ensure a positive and precise operation.

CLAYMORE

Fitted to Last



Fittings for Doors 22

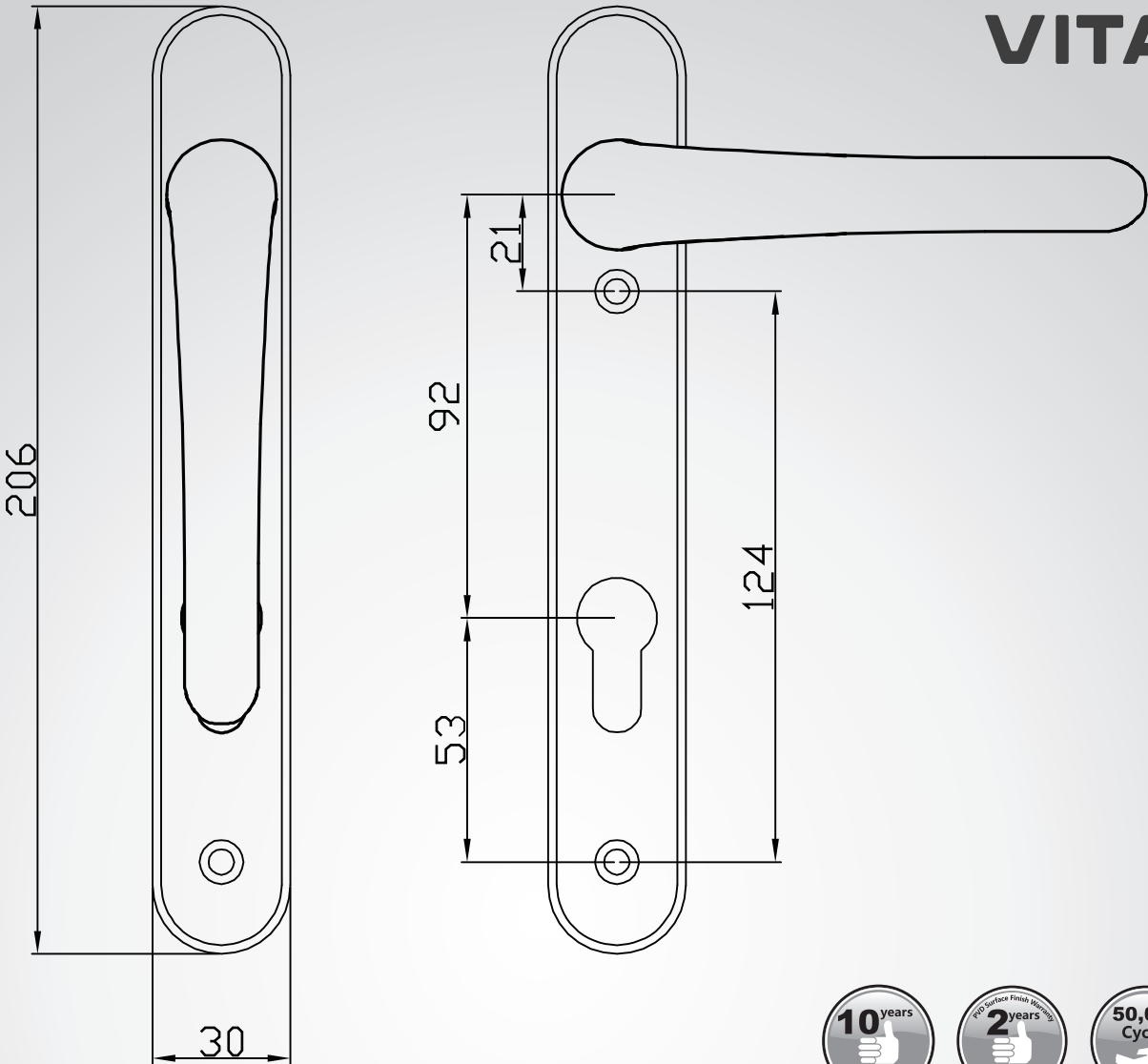

Colour	Coating Type	BS EN 1670 : 2007
White	Powder Coat	Grade 5 (480 hours)
Black	Powder Coat	Grade 5 (480 hours)
Polished Gold	Physical Vapour Deposition	Grade 5 (480 hours)
Polished Chrome	Physical Vapour Deposition	Grade 5 (480 hours)
Polished Chrome	Electro-Plating	Grade 4 (240 hours)
Smoked Chrome	Physical Vapour Deposition	Grade 5 (480 hours)
Satin Silver	Physical Vapour Deposition	Grade 4 (240 hours)

Spindle Pack	Content	Usage
Pack A	1*spindle 130mm 2*screws 85mm	For 65 mm to 70mm thick doors
Pack B	1*spindle 120mm 2*screws 75mm	For 58mm to 60mm thick doors
Pack C	1*spindle 105mm 2*screws 60mm	For 44mm Composite thick doors

AVAILABLE COLOURS

- White
- Black
- Polished Gold PVD
- Polished Chrome PVD
- Polished Chrome
- Smoked Chrome PVD
- Satin Silver PVD



FEATURES & BENEFITS

- Lever/pad variant: non-handed
- Suitable for 92 PZ centres
- 30mm backplate width; blank backplate option available to special order
- Spring cassette option
- Supplied with 1x8mm spindle and screw pack included as standard for 70mm door thickness
- Die-cast Zinc Alloy
- 2 year surface finish guarantee thanks to durable PVD coating
- Colour co-ordinated screw heads
- Packed as 1 pair per box, 20 boxes per carton

DOOR HANDLE
DH 314

This lever/pad door handle compliments the Claymore series of window handles, hinges and Zinc framed letterplates. Designed for applications where a short backplate is required, the fixings are sited below the handle grip. The door handle is designed to incorporate two internal spring cassettes if required, to ensure a positive and precise operation.

CLAYMORE

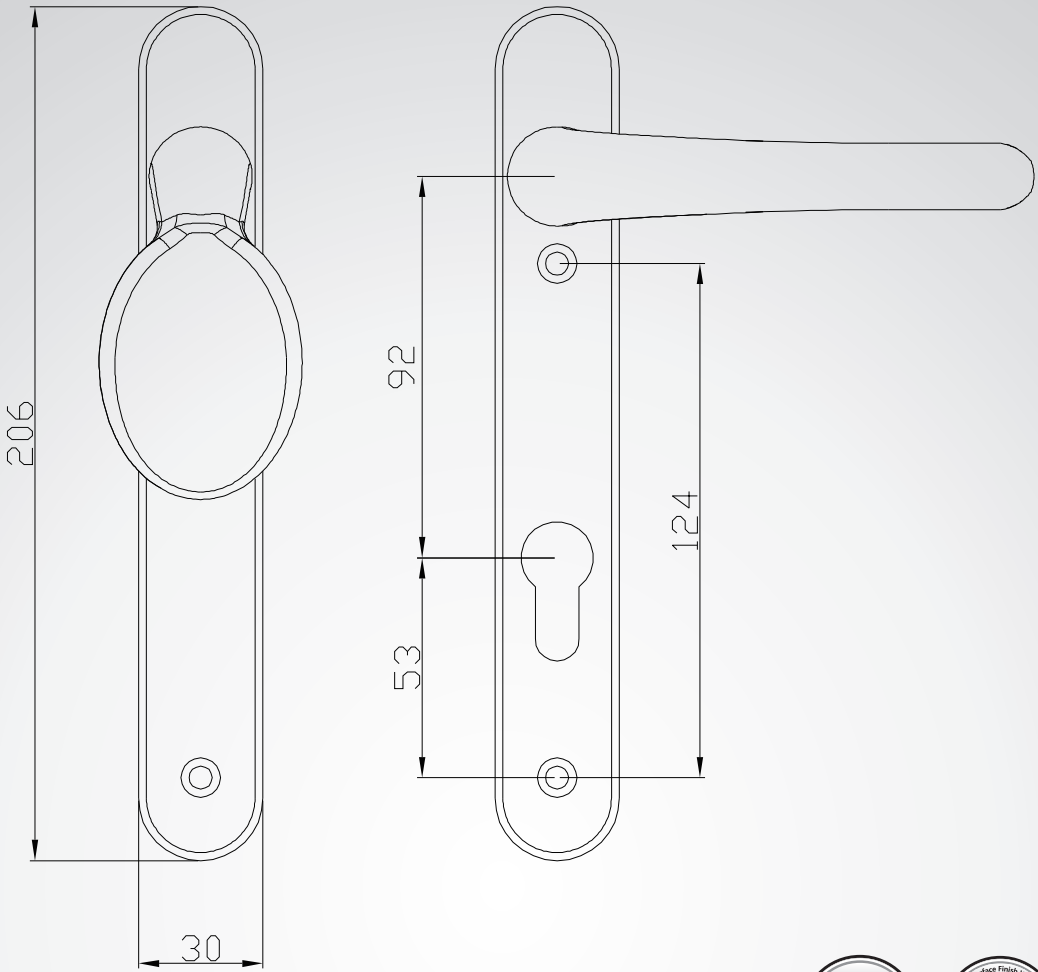

Colour	Coating Type	BS EN 1670 : 2007
White	Powder Coat	Grade 5 (480 hours)
Black	Powder Coat	Grade 5 (480 hours)
Polished Gold	Physical Vapour Deposition	Grade 5 (480 hours)
Polished Chrome	Physical Vapour Deposition	Grade 5 (480 hours)
Polished Chrome	Electro-Plating	Grade 4 (240 hours)
Smoked Chrome	Physical Vapour Deposition	Grade 5 (480 hours)
Satin Silver	Physical Vapour Deposition	Grade 4 (240 hours)

Spindle Pack	Content	Usage
Pack A	1*spindle 130mm 2*screws 85mm	For 65 mm to 70mm thick doors
Pack B	1*spindle 120mm 2*screws 75mm	For 58mm to 60mm thick doors
Pack C	1*spindle 105mm 2*screws 60mm	For 44mm Composite thick doors

AVAILABLE COLOURS

- White
- Black
- Polished Gold PVD
- Polished Chrome PVD
- Polished Chrome
- Smoked Chrome PVD
- Satin Silver PVD



FEATURES & BENEFITS

- Lever/lever variant: non-handed
- 32mm backplate width; blank backplate option available
- Tested to PAS 23-1: 1999 Clause 6.11
- Die-cast Aluminium or Zinc Alloy
- 2 year surface finish guarantee thanks to durable PVD coating
- Porcel Coat offering a durable surface finish, exceeding 3,000 hours neutral salt spray when tested in accordance to BS EN 1670:2007
- Supplied with 1x8mm spindle and screw pack included as standard for 70mm door thickness
- Colour co-ordinated screw heads
- Packed as 1 pair per box, 20 boxes per carton



DOOR HANDLE
DH 312

The Claymore Lever/Lever door handle compliments the Claymore series of window handles, hinges and Zinc-framed letterplates.

Designed for applications where a long backplate is required, the fixings are sited above and below the handle grip. Each handle set is supplied with two twin internal spring cassettes, to ensure a positive and precise operation.

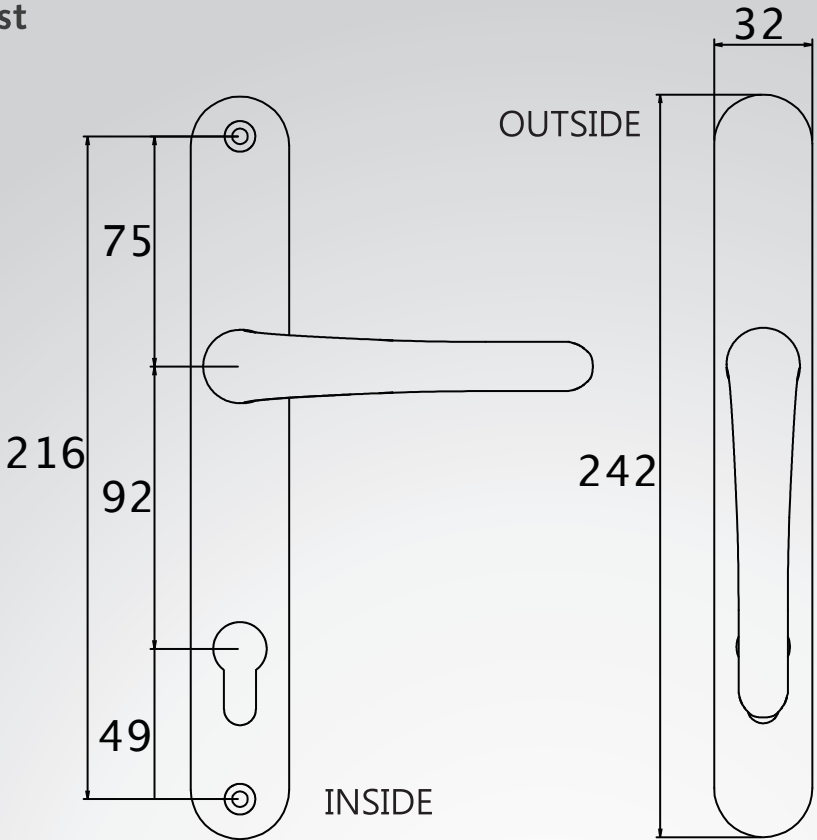

* Suitable for 92 PZ centres (48, 62, 68 , 85 and 117 available on special request)

Colour	Coating Type	BS EN 1670 : 2007
White	Powder Coat	Grade 5 (480 hours)
Black	Powder Coat	Grade 5 (480 hours)
Polished Gold	Physical Vapour Deposition	Grade 5 (480 hours)
Polished Chrome	Physical Vapour Deposition	Grade 5 (480 hours)
Polished Chrome	Electro-Plating	Grade 4 (240 hours)
Smoked Chrome	Physical Vapour Deposition	Grade 5 (480 hours)
Satin Silver	Physical Vapour Deposition	Grade 4 (240 hours)
F1 Silver	Anodised	Grade 4 (240 hours)
F3 Gold	Anodised	Grade 4 (240 hours)
Lava Brown	Porcel Coat	Tested to 3,000 hours
Black Onyx	Porcel Coat	Tested to 3,000 hours
Moët Gold	Porcel Coat	Tested to 3,000 hours

Spindle Pack	Content	Usage
Pack A	1*spindle 130mm 2*screws 85mm	For 65 mm to 70mm thick doors
Pack B	1*spindle 120mm 2*screws 75mm	For 58mm to 60mm thick doors
Pack C	1*spindle 105mm 2*screws 60mm	For 44mm Composite thick doors
Pack D	1*spindle 120mm 2*screws 85mm	For F1 Silver Anodised or F3 Gold Anodised handles and 65mm to 70mm thick doors



AVAILABLE COLOURS

- White
- Black
- Polished Gold PVD
- Polished Chrome PVD
- Polished Chrome
- Smoked Chrome PVD
- Satin Silver PVD
- F1 Silver Anodised
- F3 Gold Anodised
- Lava Brown
- Black Onyx
- Moët Gold



FEATURES & BENEFITS

- Lever/Pad variant: non-handed
- Dual spindle locks suitable for 92/62 PZ centres
- Designed for front door application
- 32mm width, blank backplate option available
- Die-cast Aluminium or Zinc Alloy
- 2 year surface finish guarantee thanks to durable PVD coating
- Porcel Coat offering a durable surface finish, exceeding 3,000 hours neutral salt spray when tested in accordance to BS EN 1670:2007
- Colour co-ordinated screw heads
- Packaged 1 pair per box, 20 boxes per carton



DOOR HANDLE
04 313

The Claymore Lever/Pad door handle compliments the Claymore series of window handles, hinges and Zinc-framed letterplates.
Designed for applications where a long backplate is required, the fixings are sited above and below the handle grip.
Each handle set supplied with two twin internal spring cassettes, to ensure a positive and precise operation.

CLAYMORE

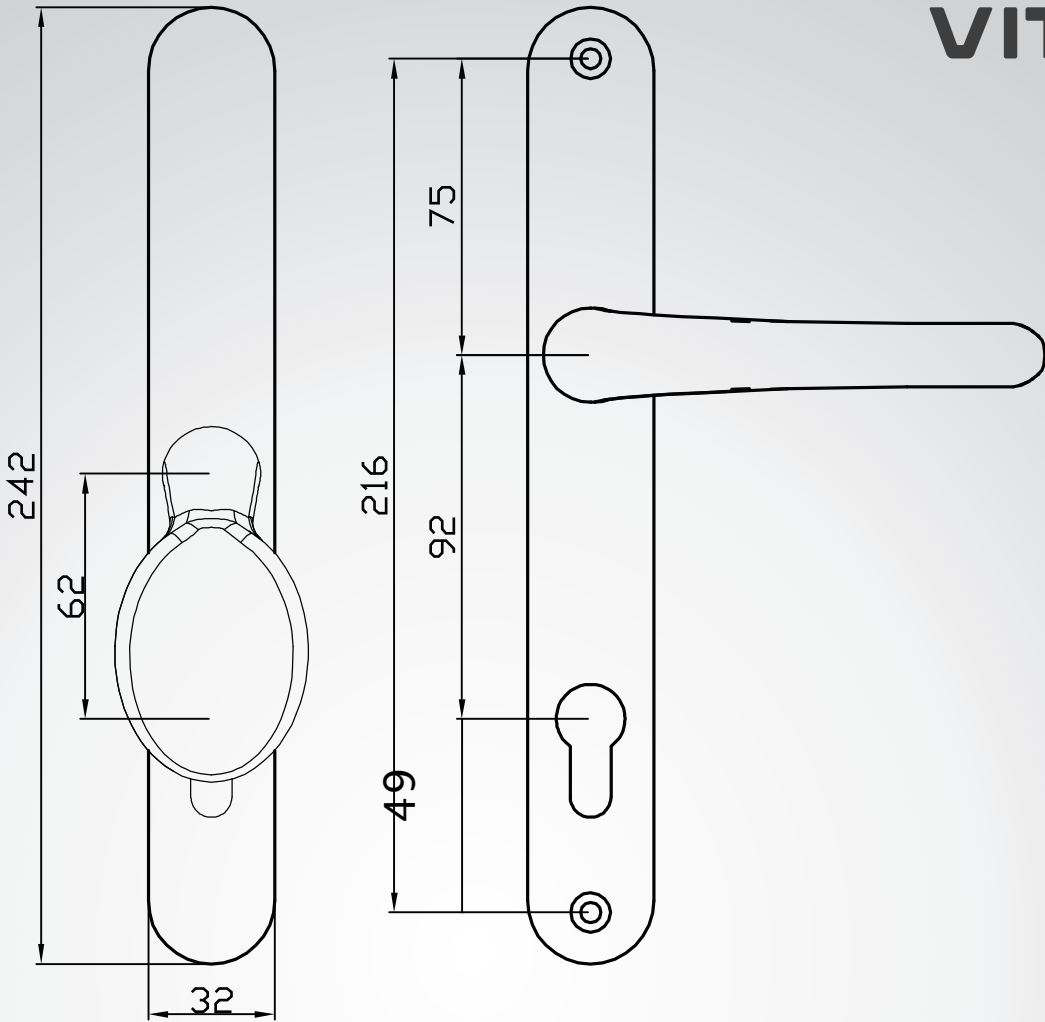

* Available with 92/92 direct drive



Colour	Coating Type	BS EN 1670 : 2007
White	Powder Coat	Grade 5 (480 hours)
Black	Powder Coat	Grade 5 (480 hours)
Polished Gold	Physical Vapour Deposition	Grade 5 (480 hours)
Polished Chrome	Physical Vapour Deposition	Grade 5 (480 hours)
Polished Chrome	Electro-Plating	Grade 4 (240 hours)
Smoked Chrome	Physical Vapour Deposition	Grade 5 (480 hours)
Satin Silver	Physical Vapour Deposition	Grade 4 (240 hours)
Lava Brown	Porcel Coat	Tested to 3,000 hours
Black Onyx	Porcel Coat	Tested to 3,000 hours
Moët Gold	Porcel Coat	Tested to 3,000 hours

Spindle Pack	Content	Usage
Pack E	2 * spindle 95mm	for 65-70mm door thickness

AVAILABLE COLOURS

- White
- Black
- Polished Gold PVD
- Polished Chrome PVD
- Polished Chrome
- Smoked Chrome PVD
- Satin Silver PVD
- Lava Brown
- Black Onyx
- Moët Gold



Fittings for Doors 29



FEATURES & BENEFITS

- Full 3-D adjustability with a standard Allen key (Lateral Adjustment $\pm 5\text{mm}$, Height Adjustment $+5\text{mm}$, Compression Adjustment $\pm 2\text{mm}$)
- Sash Max. Load: 100kg
- Covers sash rebates from 14mm to 23mm, without the use of plastic packers
- Standard frame parts: 16mm and 21mm
- Plastic shoe packer and additional flat packers available for a greater range of applications
- Packaged as 1 per box, 30 boxes per carton

3D FLAG
HINGE
FH 0900

The Claymore 3D adjustable flag hinge was developed to facilitate the optimum fix to modern PVC-u door profiles. This second generation hinge evolved from the original KFH range, retaining its strong characteristics with the added advantage of a soft sculptured shape that enhances the overall appearance of any door when fitted to modern ovulo decorative profiles.

CLAYMORE

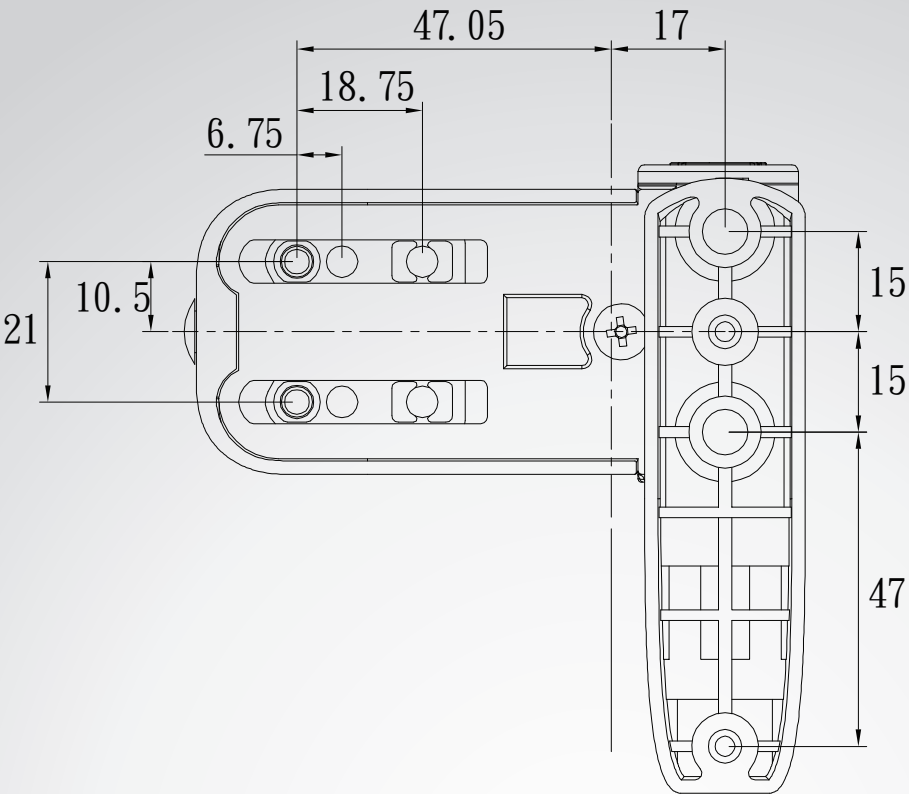

3D JIG

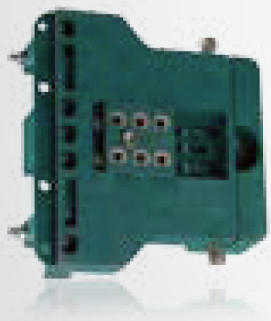

FH jig providing fast accurate drilling method

Colour	Coating Type	BS EN 1670 : 2007
White	Powder Coat	Grade 5(480 hours)
Black	Powder Coat	Grade 5(480 hours)
Brown	Powder Coat	Grade 5(480 hours)
Caramel	Powder Coat	Grade 5(480 hours)
Polished Gold	Physical Vapour Deposition	Grade 5(480 hours)
Polished Chrome	Physical Vapour Deposition	Grade 5(480 hours)
Polished Chrome	Electro-Plating	Grade 4 (240hours)
Smoked Chrome	Physical Vapour Deposition	Grade 5(480 hours)
Satin Silver	Physical Vapour Deposition	Grade 4(240 hours)

AVAILABLE COLOURS

- White
- Black
- Brown
- Caramel
- Polished Gold PVD
- Polished Chrome PVD
- Polished Chrome
- Smoked Chrome PVD
- Satin Silver PVD

Fittings for Doors 30



FEATURES & BENEFITS

- Full 3-D adjustability with a standard Allen key (Lateral Adjustment $\pm 5\text{mm}$, Height Adjustment $+5\text{mm}$, Compression Adjustment $\pm 2\text{mm}$)
- Sash Max. Load: 100kg
- Covers sash rebates from 14mm to 23mm, without the use of plastic packers
- Standard frame parts: 16mm and 21mm
- Plastic shoe packer and additional flat packers available for a greater range of applications
- Supplied with high security fixings
- Specific Ovulo packers available to special order
- Packaged as 1 per box, 30 boxes per carton



3D FLAG
HINGE
FH 103

The Claymore 3D adjustable flag hinge was developed to facilitate the optimum fix to modern PVC-u door profiles. This second generation hinge evolved from the original KFH range, retaining its strong characteristics with the added advantage of a soft sculptured shape that enhances the overall appearance of any door when fitted to modern ovulo decorative profiles.

CLAYMORE

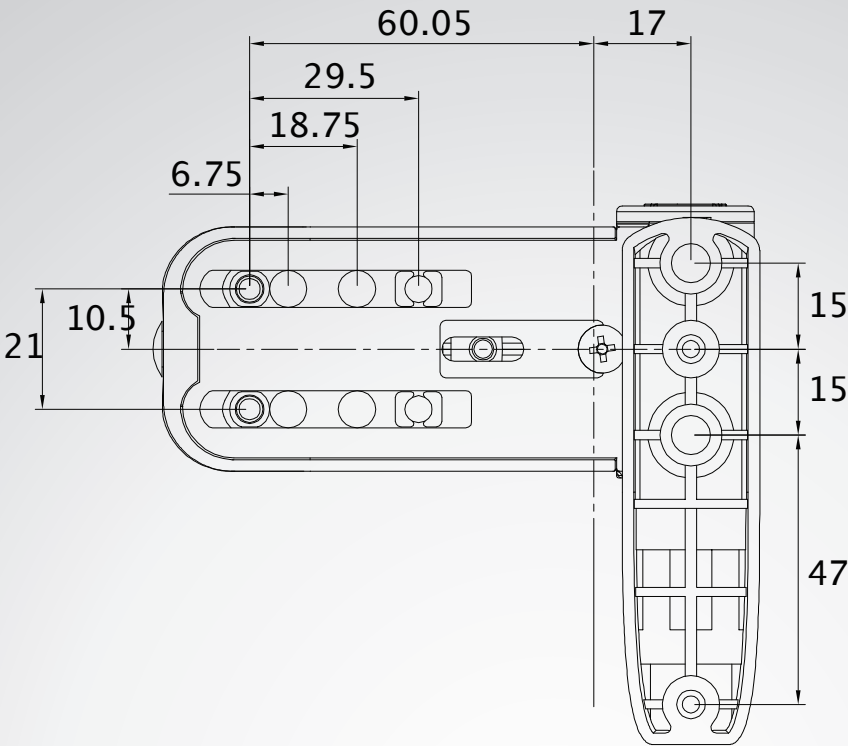

3D JIG

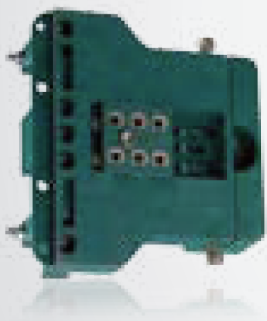

FH jig providing fast accurate drilling method

Colour	Coating Type	BS EN 1670 : 2007
White	Powder Coat	Grade 5 (480 hours)
Black	Powder Coat	Grade 5 (480 hours)
Brown	Powder Coat	Grade 5 (480 hours)
Caramel	Powder Coat	Grade 5 (480 hours)
Polished Gold	Physical Vapour Deposition	Grade 5 (480 hours)
Polished Chrome	Physical Vapour Deposition	Grade 5 (480 hours)
Polished Chrome	Electro-Plating	Grade 4 (240 hours)
Smoked Chrome	Physical Vapour Deposition	Grade 5 (480 hours)
Satin Silver	Physical Vapour Deposition	Grade 4 (240 hours)

AVAILABLE COLOURS

- White
- Black
- Brown
- Caramel
- Polished Gold PVD
- Polished Chrome PVD
- Polished Chrome
- Smoked Chrome
- Satin Silver PVD



FEATURES & BENEFITS

- Suitable for use on PVC-u, Composite and Timber doors
- All letterplates supplied with 2 x M5 fixing screws
- Standard product suitable for internal/face fix applications
- Available in two variants to cover midrail and panel applications
- Four-sided external flap seal fitted, in conjunction with brush pile draught excluder
- External and internal flaps open to 180 degrees for optimum access
- 12", accepting full A4-sized mail, aperture size conforming to BS EN 13724:2002
- Packaged as 1 per box, 16 boxes per carton



KPLP ZINC
FRAMED
LETTERPLATE

Strong, but elegant in style, the Claymore letterplate is very suitable for fitting to high quality composite and timber doors. The flaps and main body manufactured exclusively from precision Zinc Alloy Die-castings, offer a stable base material for high performance coatings, such as PVD.

CLAYMORE

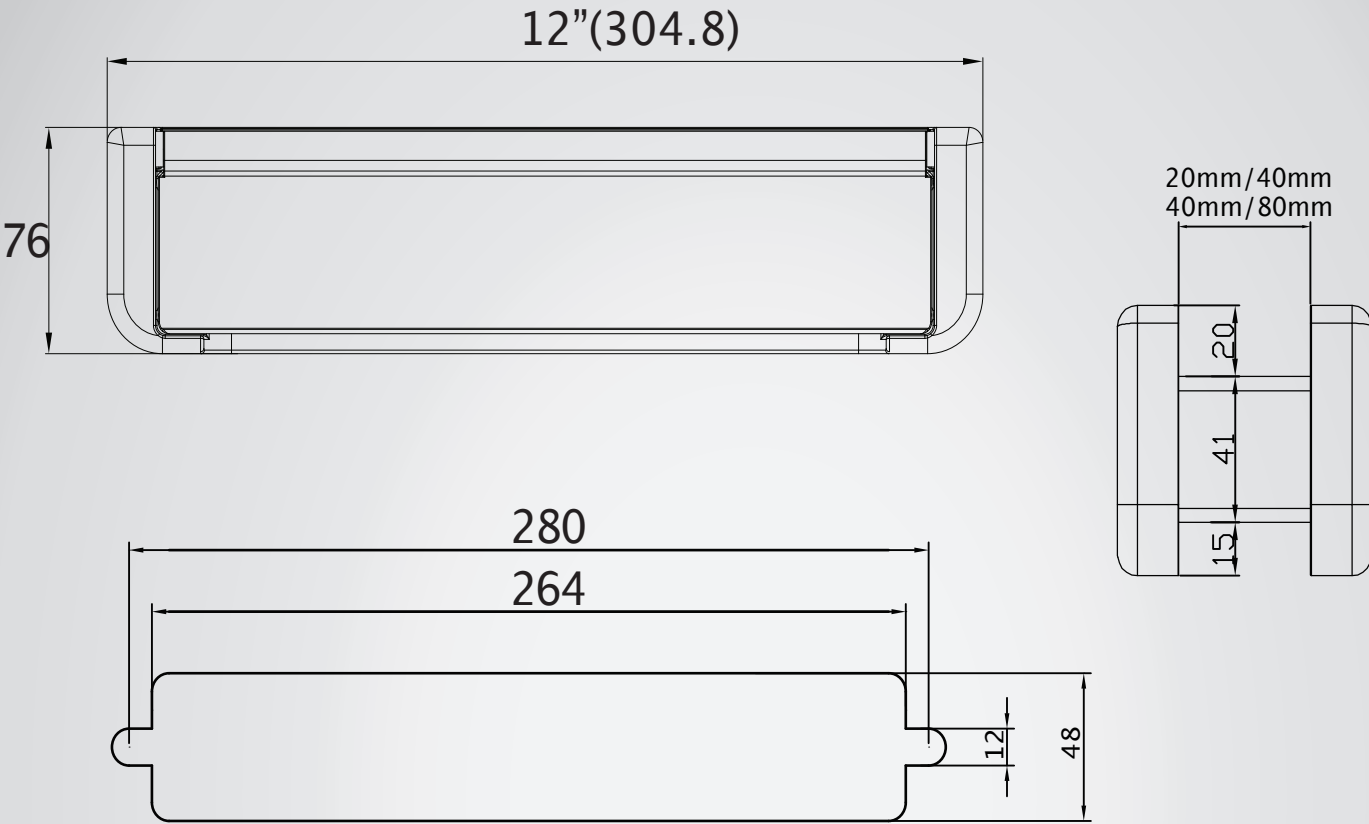

Colour	Coating Type	BS EN 1670 : 2007
White	Powder Coat	Grade 5 (480 hours)
Black	Powder Coat	Grade 5 (480 hours)
Polished Gold	Physical Vapour Deposition	Grade 5 (480 hours)
Polished Chrome	Physical Vapour Deposition	Grade 5 (480 hours)
Polished Chrome	Electro-Plating	Grade 4 (240 hours)
Smoked Chrome	Physical Vapour Deposition	Grade 5 (480 hours)
Satin Silver	Physical Vapour Deposition	Grade 4 (240 hours)

Product	Letterplate Size	Accessories
KPLP 2040	12 inch	2*M5 25mm/45mm screws for door panels up to 38mm
KPLP 4080	12 inch	2*M5 45mm/70mm screws for mid rails up to 78mm

AVAILABLE COLOURS

- White
- Black
- Polished Gold PVD
- Polished Chrome PVD
- Polished Chrome
- Smoked Chrome PVD
- Satin Silver PVD



Fittings for Doors 35



DOOR KNOCKER
DK 001

FEATURES & BENEFITS

- Face fix as standard, invisible fixing
- Cast from high quality Zinc alloy
- Available with spyhole option
- Spyhole viewer can be purchased separately
- Available in six standards finishes
- Packaged as 10 per box, 40 boxes per carton

Vita's door knockers are contemporary in style and available with or without a spyhole option. Each set comprising of an invisible fixing kit. The knocker is available in six standard finishes to perfectly match the Claymore door range. Letters and numerals available on request to make the Claymore door experience complete.

CLAYMORE

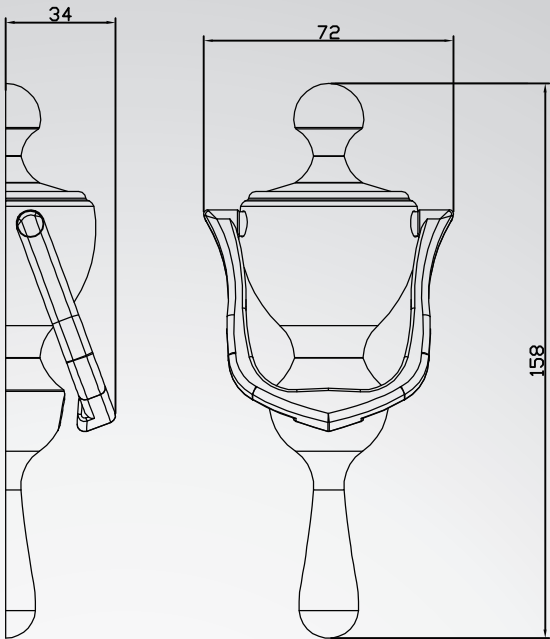
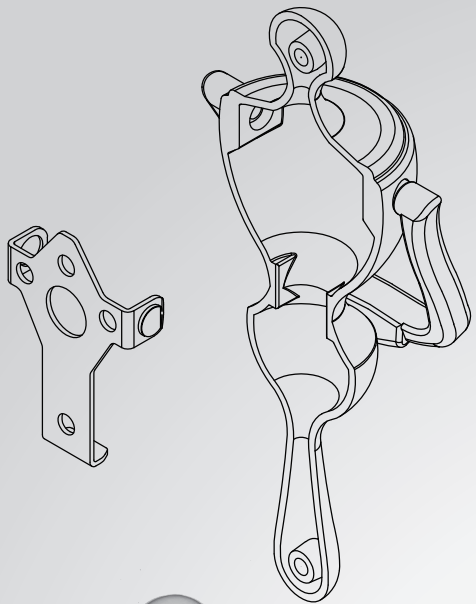

spyhole option

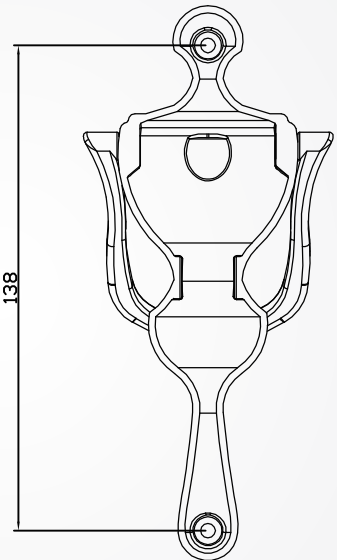

Fittings for Doors 36

Colour	Coating Type	BS EN 1670 : 2007
White	Powder Coat	Grade 5 (480 hours)
Black	Powder Coat	Grade 5 (480 hours)
Polished Gold	Physical Vapour Deposition	Grade 5 (480 hours)
Polished Chrome	Physical Vapour Deposition	Grade 5 (480 hours)
Smoked Chrome	Physical Vapour Deposition	Grade 5 (480 hours)
Satin Silver	Physical Vapour Deposition	Grade 4 (240 hours)

Product Code	Product Type
DK 001K	Without spyhole
DKV 001	Spyhole option

AVAILABLE COLOURS

- White
- Black
- Polished Gold PVD
- Polished Chrome PVD
- Smoked Chrome PVD
- Satin Silver PVD

Letters and numerals to special order

Fitted to Last



FEATURES & BENEFITS

- All letterplates supplied with 2 x fixing screws
- Suitable for doors from 20mm to 80mm
- Available in two variants to cover midrail and panel applications
- External and internal flaps open to 180 degrees for optimum access
- 12", accepting full A4-sized mail, aperture size conforming to BS EN 13724:2002
- Packaged as 1 per box, 30 boxes per carton

Fittings for Doors 37

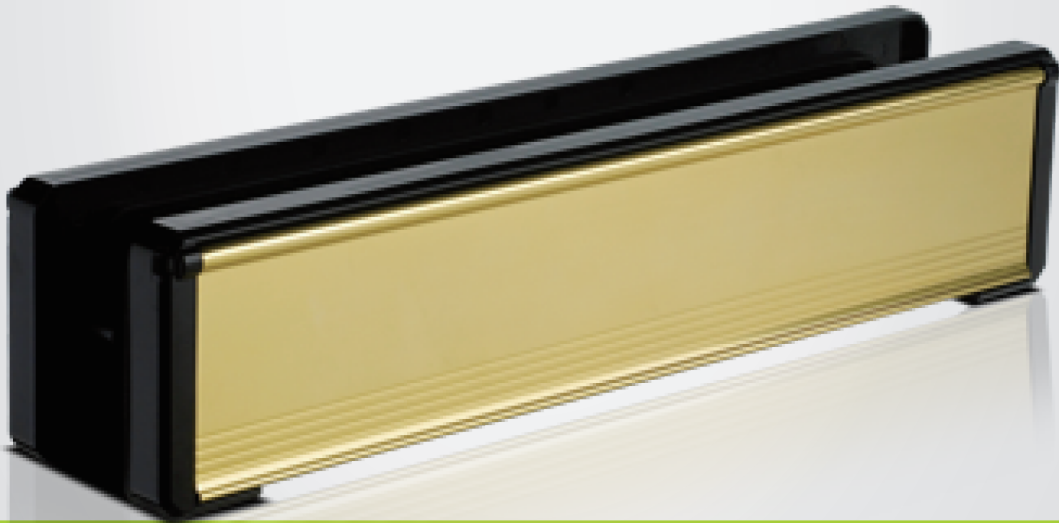

ABS FRAMED
LETTERPLATE

Vita's range of ABS framed letterplates plates are designed to give a maximum of 180 degrees opening to aid the delivery of mail. Forged with quality extruded aluminum and available in a variety of fine finishes.

Fitted to Last

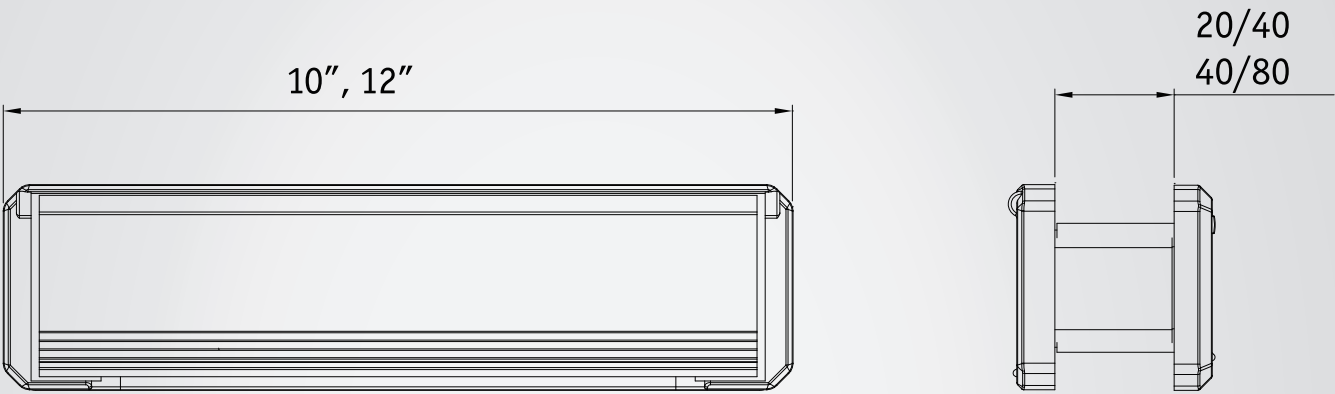

Fittings for Doors 38



Colour	Coating Type	BS EN 1670 : 2007
White	Powder Coat	Grade 5 (480 hours)
Black	Powder Coat	Grade 5 (480 hours)
Polished Gold	Anodised	Grade 4 (240 hours)
Polished Chrome	Electro-Plating	Grade 4 (240 hours)
F1 Silver	Anodised	Grade 4 (240 hours)
F3 Gold	Anodised	Grade 4 (240 hours)

Product	Letterplate Size	Door Thickness
LTP 2040-12	12 inch	20-40mm
LTP 4080-12	12 inch	40-80mm
LTP 2040-10	10 inch	20-40mm
LTP 4080-10	10 inch	40-80mm

AVAILABLE COLOURS

WH

White

BL

Black

GD

Polished Gold

PC

Polished Chrome

SS

F1 Silver Anodised

SG

F3 Gold Anodised



FEATURES & BENEFITS

- Designed to meet the requirements of PAS23/24
- Single or Dual spindle options
- 35mm backset
- Three opposing steel hooks
- Bi-directional throw of hooks for enhanced security
- Adjustable roller cams
- Slave lock variant
- Reversible latch to minimise stocking
- Snib facility as standard on all locks
- Fully adjustable, one-piece keep and multi-keep system available
- Through fix one-piece keep
- Keep adjustability +/-2.0mm
- High security shootbolt
- Packaged as 5 per box

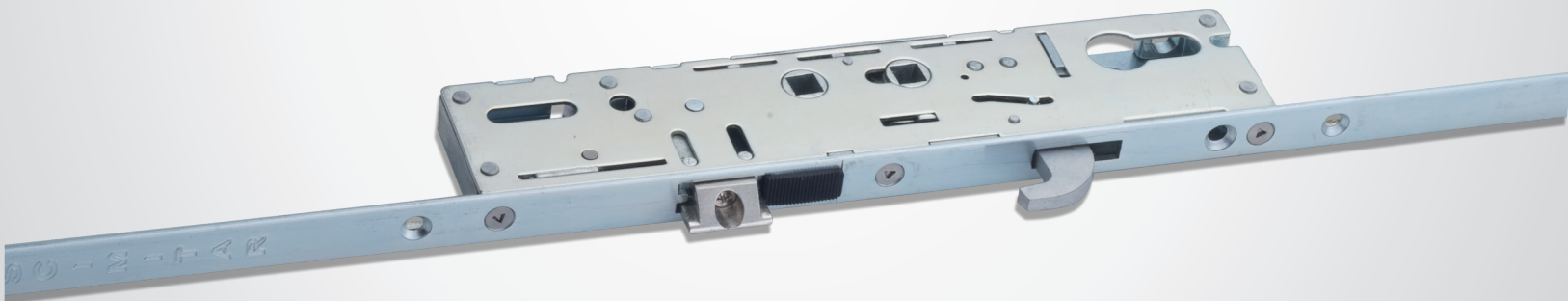

MULTI-POINT
DOOR LOCK
FOR PVC-U

Designed and developed to meet the requirements of PAS 23/24, the Scimitar Bi-directional Multi-point Door Lock offers enhanced security and reliability, in conjunction with ease of assembly and smooth operation. The lock's strength is achieved through the fitment of three steel hooks, which ensures that anti-separation of the PVC-u sash and frame is maintained whilst engaged in the locked position. Adjustment to gasket compression is achieved by either the two adjustable roller cams, or fully adjustable keeps.

SCIMITAR



Available in both a single or dual spindle variant, the Scimitar covers the full spectrum of applications, ranging from short back plate door handles on the single spindle lock, to dual spindle, which covers Front door, Back door and French doors all from the one router detail, with a long back plate door handle. All Scimitar locks are supplied fully serrated top and bottom to cover French door systems and shootbolt applications.

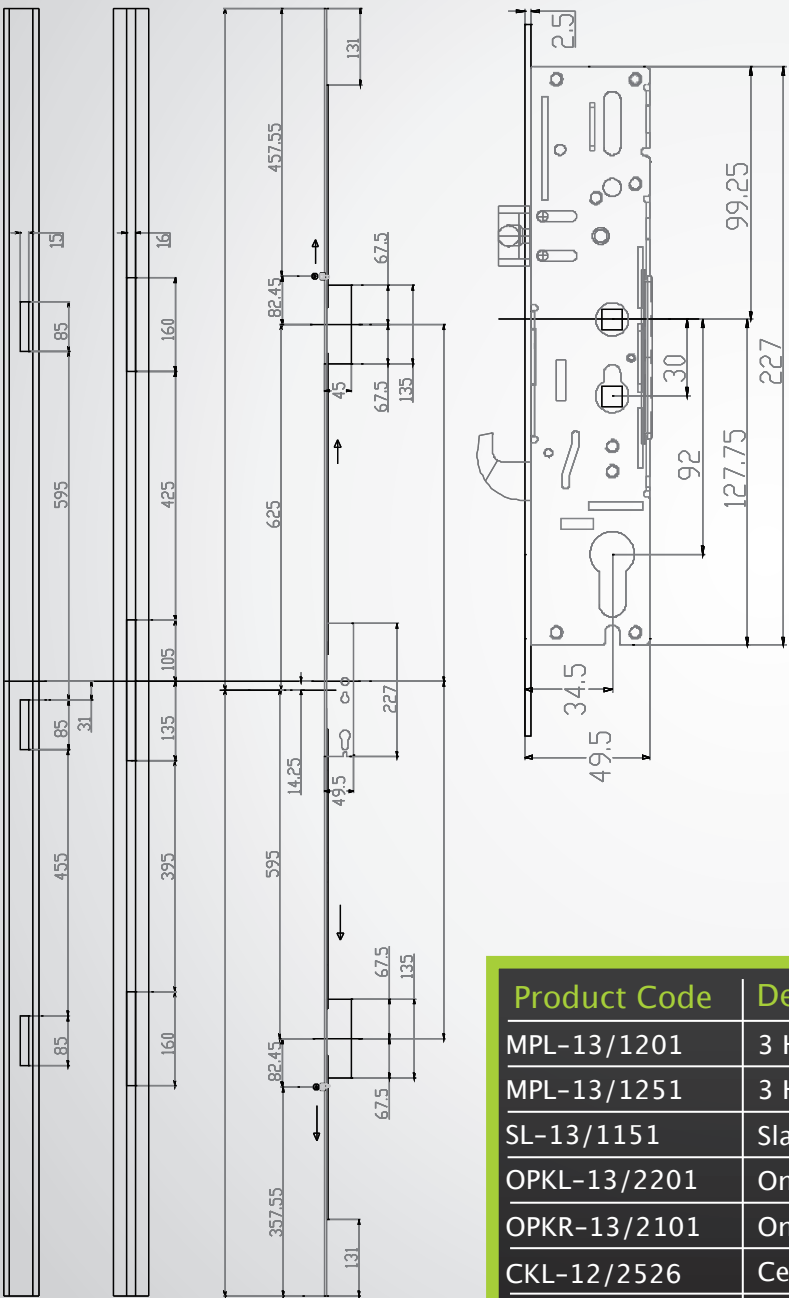

All locks supplied in a Silver Trivalent finish to comply to BS EN 1670 Grade 4 (240 hours)

Product Code	Description
MPL-13/1201	3 Hooks, 2 Rollers & Latch 92mm PZ Single Spindle
MPL-13/1251	3 Hooks, 2 Rollers & Latch 92/62mm PZ Dual Spindle
SL-13/1151	Slave Lock 92mm PZ Single Spindle
OPKL-13/2201	One Piece Keep-Left Hand
OPKR-13/2101	One Piece Keep-Right Hand
CKL-12/2526	Centre Keep-Left Hand
CKR-13/2551	Centre Keep-Right Hand
TBK-13/2501	Top & Bottom Keep Set (Pair)
MPLSB-13/3101	Mild Steele S/Bolt Set (2 Single Direction)
MPLR-13/3111	400mm Roller Extension
MPLFDK-13/2586	French Door Double Bolt Keep Set
MPLFSK-13/2576	Single Shoot Bolt Keep Set

Fitted to Last



FEATURES & BENEFITS

- Designed to meet the requirement of PAS23/24
- Secured by Design
- Dual spindle
- 35mm and 45mm backset option
- Reversible latch to minimize stocking
- Snib facility as standard
- Fully adjustable multi-keep system available
- Keep adjustability +/-3.5mm
- Face plate options, 16mm full length, 20mm round end in mild steel or stainless steel
- Packaged as 5 per box



MULTI-POINT COMPOSITE DOOR LOCK

Designed to meet the requirements of PAS 23/24 and Secured by Design, the Avantis Bi-Directional, Multi-Point Door Lock's 25mm deep throw hooks and bolt system combine to provide the ultimate in security and weather performance.

Fitted to Last

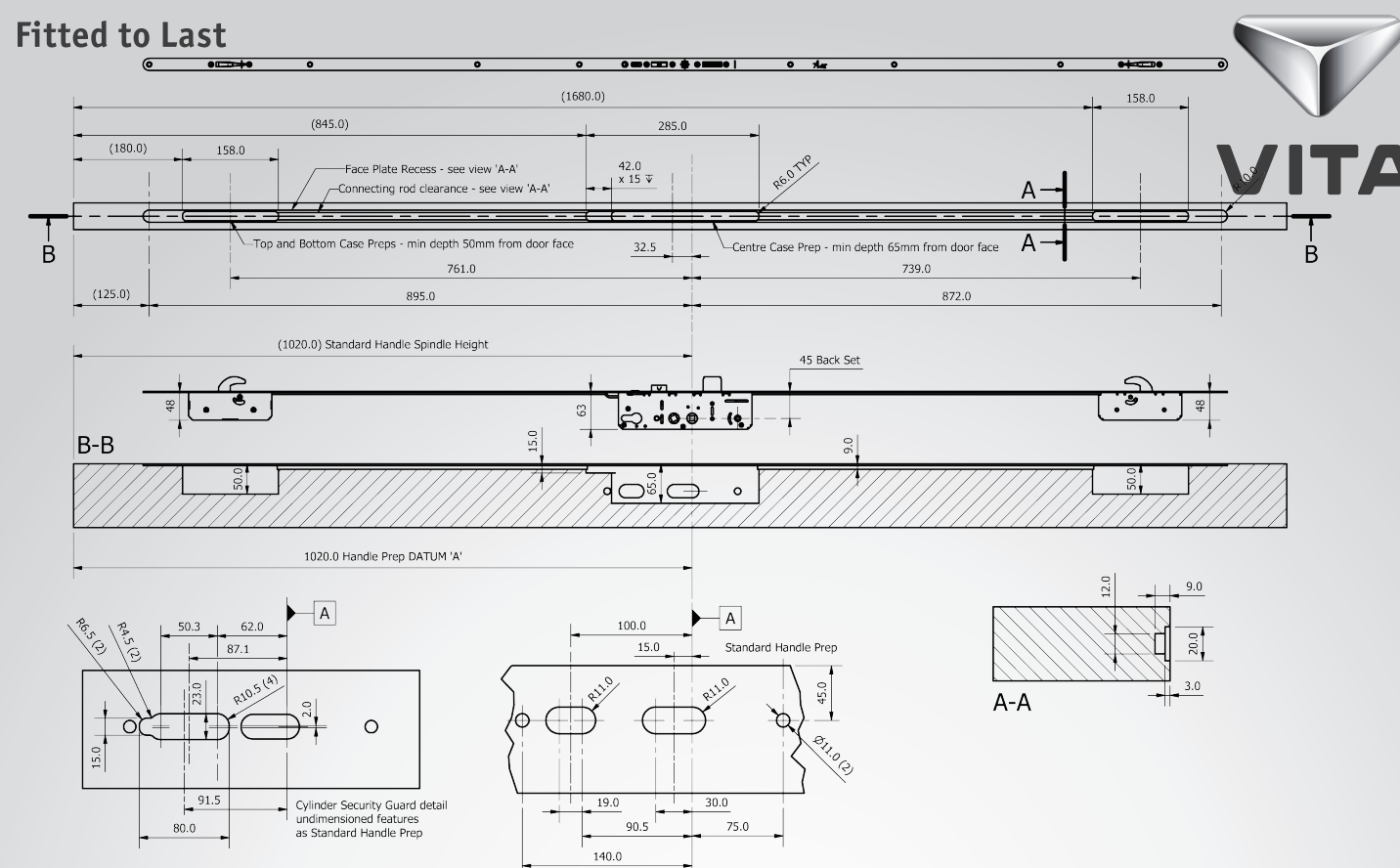

25mm deep throw bi-directional hooks for enhanced security



Multi-keep system



Available with first ever UK designed twin fix cylinder guard protection system, designed to eliminate cylinder snapping

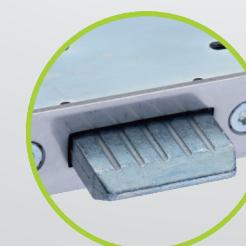

25mm horizontal centre dead bolt for enhanced security

All locks are supplied in a Silver Trivalent finish to comply to BS EN 1670 Grade 4 (240 hours).
Vita Hardware Ltd. T 01422 371384 uk.sales@vitahardware.com www.vitahardware.co.uk



FEATURES & BENEFITS

- Manufactured to BS EN 1303
- Available in Nickel or Brass variants
- 5/6 pin options
- Hardened pins and mushroom drivers
- Supplied with 3 keys & fixing screw (Yale No. 8 key blank)
- Thumb turn variant available
- Packaged as 1 per box, 50 boxes per carton



EURO
PROFILE
CYLINDER

Vita door cylinders come in a variety of lengths to suit all door thicknesses. Manufactured from solid brass, and with brass or nickel finishing as options, Vita's complete range of 5-pin and 6-pin cylinders are weatherproof and offer superior durability.

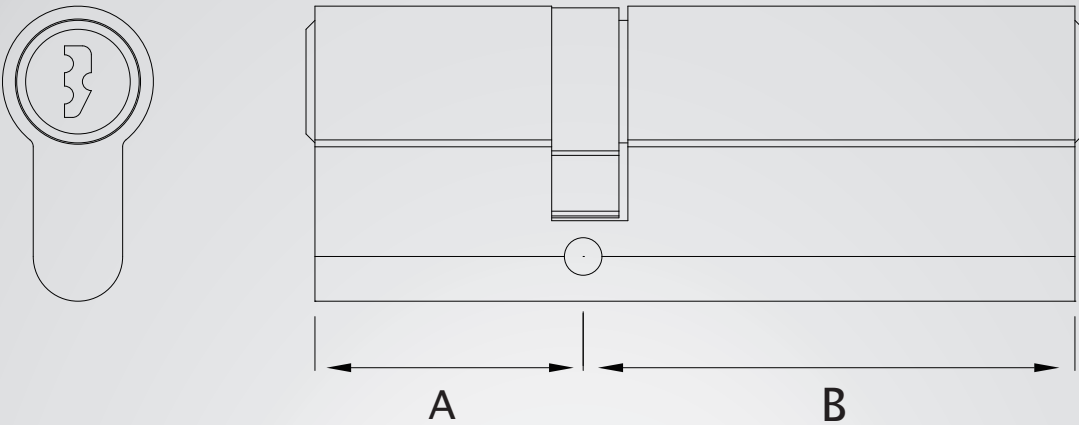

Product Code	A (mm)	B (mm)
DC 30/--	30	30
DC 35/--	35	35/45/50/55
DC 40/--	40	40/45/50/55/60
DC 45/--	45	45/50/55
DC 50/--	50	50
DC 55/--	55	70

Colour	BSEN 1670:2007
Brass (B)	Grade 3 (96hours)
Nickel(N)	Grade 3 (96hours)

	EN 1303 : 2005							
5 PIN variant	1	6	-	1	-	C	4	0
6 PIN variant	1	6	-	1	-	C	6	0

- Digit 1: Category of Use
Digit 2: Durability (Grade 6: 100,000 cycles)
Digit 3: Door Mass (not tested)
Digit 4: Fire Resistance
Digit 5: Safety (not tested)
Digit 6: Corrosion (Grade C, resistance from -20 to +80 degrees)
Digit 7: Key related security
Digit 8: Attack resistance (Grade 0: resistance to drilling Grade 2 (5 minutes))



AVAILABLE COLOURS

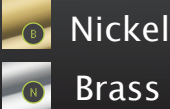



FEATURES & BENEFITS

- Friction level is easily adjustable
- Arm easily disconnectable should it be necessary to open the door or window fully.
- All materials used are durable and non-corrosive
- Restrictor arm supplied in SUS 430 stainless steel
- Packaged in 50 per box



HOLD-OPEN DOOR RESTRICTOR

Designed to locate and operate in a standard PVC-u, Aluminium and Timber euro groove, the Vita hold open door restrictor clicks into position to secure the door at 90°, with ease of disengagement by hand. With adjustment of the friction brake achieved through the use of a No2 Posi-drive screwdriver. The main arm manufactured from SUS 430 Stainless steel as standard.

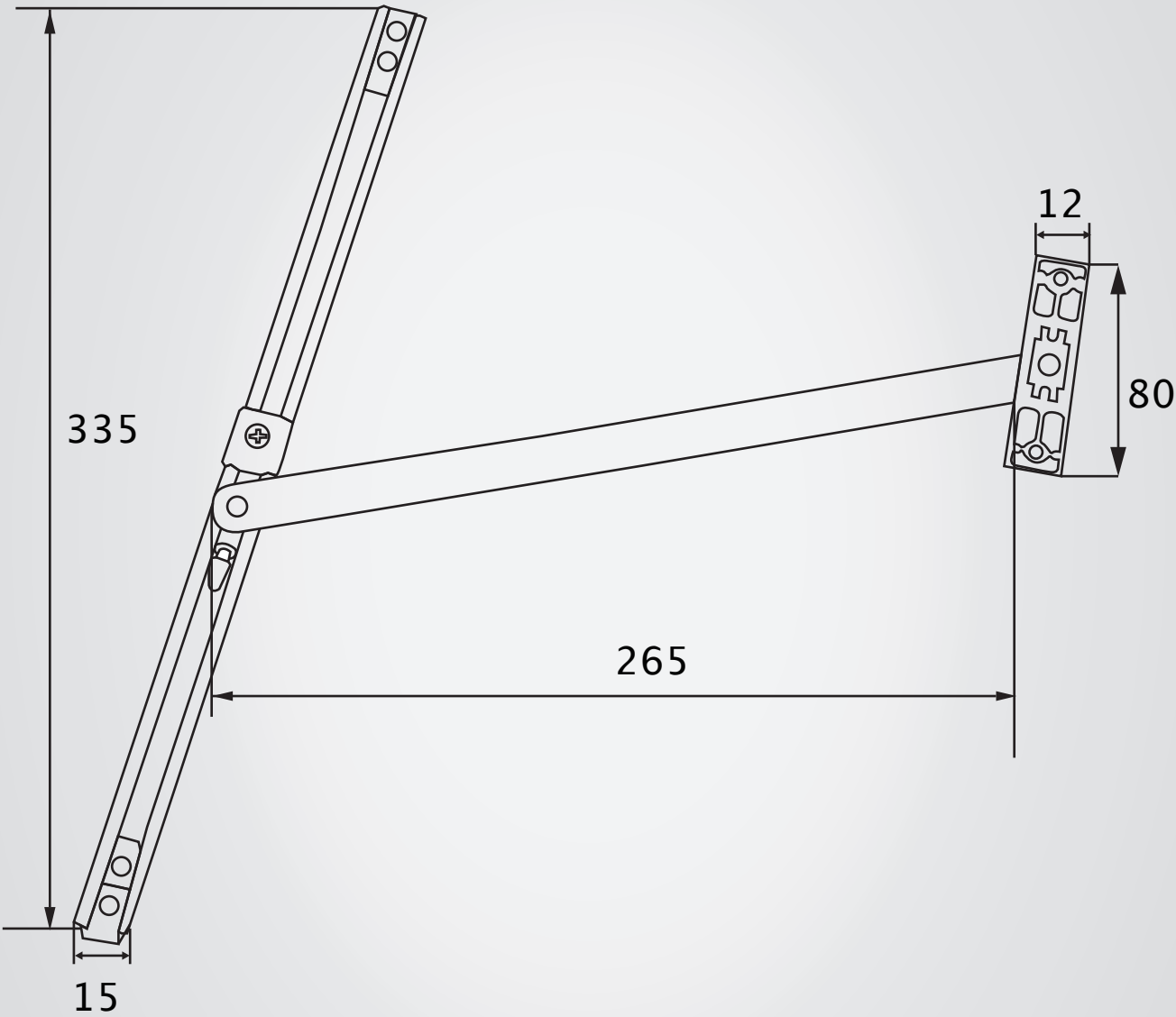

Manufactured from SUS 430 stainless steel as standard (BS EN 1670:2007 Grade 3), with the option of SUS Austenitic 304 stainless for coastal locations.

*Please note that the hold facility is robust but is not designed to cope in strong wind conditions.



Vita Hardware Ltd.

Unit B3, Lowfields Close
Lowfields Business Park
Elland, West Yorkshire
HX5 9DX, UK

T +44 1422 371384

F +44 1422 387689

uk.sales@vitahardware.com

